



INSTRUCTION MANUAL

Joëlette[®]
FINISHER

C10P159-C10P164 . Rev B . 29-03-2024.

This manual **MUST** be given to the user of the product. Read this manual **BEFORE** using this product, and keep it for future reference.
The information contained in this document is non-contractual and subject to change without notice.

The photos shown in this manual are not contractual.

INTRODUCTION	P. 4
USABILITY	P. 4
WARRANTY	P. 5
JOËLETTE FINISHER	P. 5
GENERAL INFORMATION	P. 5
<u>The pilot</u>	p. 5
<u>How to operate the Joëlette Finisher</u>	p. 6
<u>The passenger</u>	p. 6
<u>In curves</u>	p. 7
INSTALLATION OF THE PASSENGER ON THE JOËLETTE FINISHER	P. 7
<u>Transfer</u>	p. 7
<u>Passenger's security and support</u>	p. 7
<u>Comfort</u>	p. 8
SECURITY INSTRUCTIONS	P. 9
<u>Choice of trails</u>	p. 9
<u>The team</u>	p. 9
<u>Preparing the trip</u>	p. 9
<u>Insurance</u>	p. 9
<u>Rucksac</u>	p. 9
<u>During the trip</u>	p. 10
EXPLODED VIEW OF THE JOËLETTE FINISHER SIZE 42	P. 11
EXPLODED VIEW OF THE JOËLETTE FINISHER SIZE 48	P. 12
UNFOLDING THE JOËLETTE FINISHER	P. 13
MAINTENANCE	P. 16
MAINTENANCE	P. 16
CLEANING	P. 16
DISINFECTION	P. 17
INSPECTION CHECKS	P. 17
LONG-TERM STORAGE	P. 18
AFTER USE	P. 19
DISPOSAL	P. 19
TECHNICAL DATA	P. 19
HEADREST ASSEMBLY	P. 21
CONTACT	P. 22

INTRODUCTION

This user manual contains important information about the handling of the Joëlette Finisher. In order to ensure safety when using the product, read the user manual carefully and follow the safety instructions.

If you find that the font size in the print version of the user manual is difficult to read, you can download the pdf from the website www.joeletteandco.com. The pdf can then be scaled on screen to a font size that is more comfortable for you.



USABILITY

Only use the Joëlette Finisher when it is in perfect working order. Otherwise, you might put yourself and others at risk. The following list does not claim to be exhaustive. It is only intended to show some of the situations that could affect the usability of your Joëlette.

You should immediately stop using the Joëlette Finisher if its usability is restricted due to:

- damage to the braking system
- insufficient tire pressure
- damage to the belt and holding system (chest harness)
- cables that are damaged, kinked, pinched or have come loose from the fixation
- missing safety pins
- unusual sounds developing or occurring

WARRANTY

The Joëlette Finisher comes with a two years warranty. The Joëlette Finisher must be used in strict accordance with the intended use, maintenance and service requirements as set out in this document. Risk of accident and loss of warranty if maintenance is insufficient (page 16). The availability of spare parts is limited to **5 years**.

For reasons of safety and in order to avoid accidents which result from unnoticed wear, it is important that the Joëlette undergoes a multiannual inspection and minimum once every year under normal operating conditions. Under regular operating conditions, it would be expedient to carry out intermediate checks on the brakes, accessories and running gear.

If you encounter a malfunctioning problem on your Joëlette, do not intervene yourself at the risk of losing the guarantee, contact us. Any damage or error resulting from the non-observance of this manual or poor maintenance is excluded from the warranty. Do not try to carry out any work or manipulation that is not described.

JOËLETTE FINISHER

The Joëlette Finisher is a three-wheeled wheelchair that can be used by people with reduced mobility, with the help of an able-bodied companion, for running on gentle terrain (greenways, cycle paths, roads, etc.).

Its three wheels ensure stability and manoeuvrability when driving. A rear handlebar allows the support person to steer the Joëlette Finisher.

The Joëlette Finisher can be adapted to suit the physical and driving abilities of each runner over all race distances. It is designed for a wide range of users with different needs.

Two models are available with different seat widths (size 48 or 42). All the instructions are valid for both sizes. The use of the Joëlette Finisher is the sole responsibility of the accompanying person.

GENERAL INFORMATION

THE PILOT

Driving the Joëlette Finisher requires only one driver, who pushes using the rear handlebars. If necessary, additional companions can follow the Joëlette Finisher and take over the driving. To make a safe change, bring the Joëlette Finisher to a halt: apply the brake and then activate the park button.

WARNING

The Joëlette Finisher is not suitable for use on rough terrain.

Any serious incident related to the use of the Joëlette Finisher must be reported to the manufacturer.

ONLY FOR LEISURE ACTIVITIES.



HOW TO OPERATE THE JOËLETTE FINISHER

Driving the Joëlette Finisher requires a good level of physical fitness to ensure the safety of the passenger while moving the machine.

However, it is not only reserved for «great sportsmen» and women, and can also be practised in a «jogging» spirit on easier routes.

Driving the Joëlette Finisher is technical and requires a learning phase. For a comfortable driving position, position the handlebars at pelvic level.

THE PASSENGER

On the Joëlette Finisher, he feels everything! They have to tell their team-mates if they feel any discomfort. Riding a Joëlette Finisher is not an insignificant step for a person with a disability. It means giving up the autonomy you might have had with your manual or electric wheelchair and relying entirely on your team-mates for your mobility and safety!

Even severely disabled people can use the Joëlette Finisher thanks to the possibility of integrating a shell. All you have to do is install it on the original cushions by passing the shell attachment system behind the backrest.

There are many different types of disability, so riders need to make any necessary adaptations (straps, cushions, foam, etc.) beforehand to ensure everyone is comfortable.

The Joëlette Finisher can support weights of 100 kilos in size 48 and 80kg in size 42. However, for safety reasons, the weight of the passenger should not greatly exceed the weight of the rear rider (to be adjusted according to the team's capabilities and the difficulty of the route).

IN CURVES

The front wheel of the Joëlette Finisher is directional. However, in the event of too many bends, it is necessary to lean on the rear handlebars in order to raise the front wheel slightly. **However, you must remain vigilant, particularly when driving at speed.**



INSTALLATION OF THE PASSENGER ON THE JOËLETTE FINISHER

TRANSFER

Transferring the passenger onto the Joëlette Finisher is made easier because the seat is at standard wheelchair height.

Make sure that the Joëlette is in a fully stabilised position. The parking brake must be activated. The companion helps the passenger into the seat.

- One of the two front armrests can be retracted for independent lateral transfer from the wheelchair to the Joëlette Finisher.
- If the passenger is unable to get into the Joëlette on their own, the companions will help them by positioning themselves on one side of the Joëlette and lifting them into the seat.

A common carrying technique is for the carer to put their neck under the passenger's armpit, with one hand behind the back holding the waist belt and the other hand under the knees, then lift together. Other transfer techniques exist, such as the use of a patient lift.

If the passenger is in a shell, they can be transferred with their shell onto the Joëlette. To do this, position the shell on the seat cushions and use the shell's original attachment system.

In all cases, remember to take it easy when lifting the person: to do this, carry by bending your legs.

You should also make sure that your transfer technique is suitable for the person with the disability. Don't hesitate to ask her for advice: she knows her disability best and will be able to tell you what type of help she needs and what is not suitable.

PASSENGER'S SECURITY AND SUPPORT

- Before each ride, fasten the breastplate. Take care to position it correctly on the passenger (no twisting, clothes underneath, not too tight) to avoid causing discomfort.
- Adjust the height of the footrests using the 3mm hexagonal key supplied, to screw the footrests into one of the three positions. Tighten the screws securely.

CAUTION

Always adjust the rear handlebars when stationary. If you are walking, there is a risk of tipping over.





- Attach the feet to the footrests using the Velcro straps supplied.
- Use the knob to adjust the headrest to the correct height (resting against the back of the user's neck). If the headrest is incorrectly positioned, a collision could cause the neck to hyperextend. Tighten the handle securely once the headrest has been adjusted.

COMFORT

Make sure the passenger is as comfortable as possible from the outset:

- By adjusting the footrest and headrest as required. The inclination of the backrest can also be adjusted using the quick-release handles on either side of the seat (from 100° to 111°). - Make sure that the passenger's clothes and limbs are correctly positioned (they may have become crooked during the transfer).
- Beware of the risk of injury if a part (limb, clothing, etc.) comes into contact with moving parts.
- Check that no straps can be caught by the wheels or any other moving part.

Here are the basics of driving a Joëlette. It's up to you to experiment, adapting the routes to your abilities.

Above all, remember that the priority is to ensure the comfort and safety of your passenger, while having fun!



SECURITY INSTRUCTIONS

CHOICE OF TRAILS

Before setting off on your Joëlette Finisher, you need to plan the route you are going to take. The Joëlette Finisher is only suitable for use on smooth, flat terrain (cycle paths, tarmac, greenways, forest tracks, etc.).

THE TEAM

- Only one person is needed to guide the Joëlette Finisher. Additional guides can take over the driving, depending on the difficulty of the route, the driving experience of the drivers and the weight of the passenger.
- Pilots who are physically able to take on the role of driving the Joëlette Finisher.
- Be careful not to overestimate the physical and technical capabilities of the riders.

PREPARING THE TRIP

- Set off on a pre-planned route.
- Choose the route according to the physical and technical capabilities of the team of drivers.
- Check that your Joëlette Finisher is in good working order. Mechanical check before the race.
- Check the weather forecast. If there is a risk of thunderstorms, do not set off (because of its metal construction, the Joëlette Finisher attracts lightning). You should also be aware that a route that can be completed with a Joëlette Finisher in good weather can become dangerous in wet weather.
- Let those around you know the route you intend to take.

INSURANCE

It is compulsory for each accompanying person to have civil liability insurance. The use of the Joëlette Finisher does not require specific insurance, but you should inform your insurer of this.

RUCKSAC

- Usual running gear (first aid kit, water and provisions, suitable clothing, etc.).
- Mobile phone to call for help in an emergency (European emergency number 112 or the number of the local PGHM).

- Repair equipment for the Joëlette (adapted tools, spare inner tube or spray for the wheels, etc.), small breakdown equipment (straps, turnbuckles, etc.).
- For the passenger, who can quickly be in a sensitive position with regard to the cold, bring warm clothing. Don't forget to protect extremities (gloves, hat, etc.) and, if necessary, take a protective cover against the cold («extreme cold cover»). Don't forget to take a poncho-type rain protector, which can also be used to protect the passenger and the Joëlette Finisher's equipment (cushions, headrests, etc.).

DURING THE TRIP

- Passengers must wear a mountain bike helmet.
- Good shoes for drivers of the Joëlette Finisher.
- Adjust the height of the rear handlebars so that they are not above the pelvis.
- Do not drive the Joëlette Finisher if you feel too tired. Know and respect your own limits.
- Check that there is no risk of straps or clothing becoming entangled in the rotating parts.
- Don't go too fast: You need to know where the wheel is going, where your feet are and not trip or slip.
- In cold weather, make sure that passengers do not run the risk of hypothermia due to their immobile position and sometimes to their pathology (circulatory problems, loss of sensitivity so that they cannot feel the cold, etc.).
- Do not leave a Joëlette Finisher with the parking brake on without someone behind, especially if the passenger has uncontrolled movements.
- Beware of falling in difficult places, near ravines or on slippery ground!
- But remember that falls don't happen on tricky sections of the route, but rather on quiet stretches, because of a lack of vigilance.
- Be careful not to get too close to a flame, as there is a risk of tissue ignition.
- It is recommended that passengers stand up and/or change position at least every 2 hours to limit the risk of pressure sores (coccygeal, ischial, spinal);
- Check that the parts of the Joëlette Finisher in contact with the passenger's skin are not excessively hot (which could cause burns).

EXPLODED VIEW OF THE JOËLETTE FINISHER SIZE 42

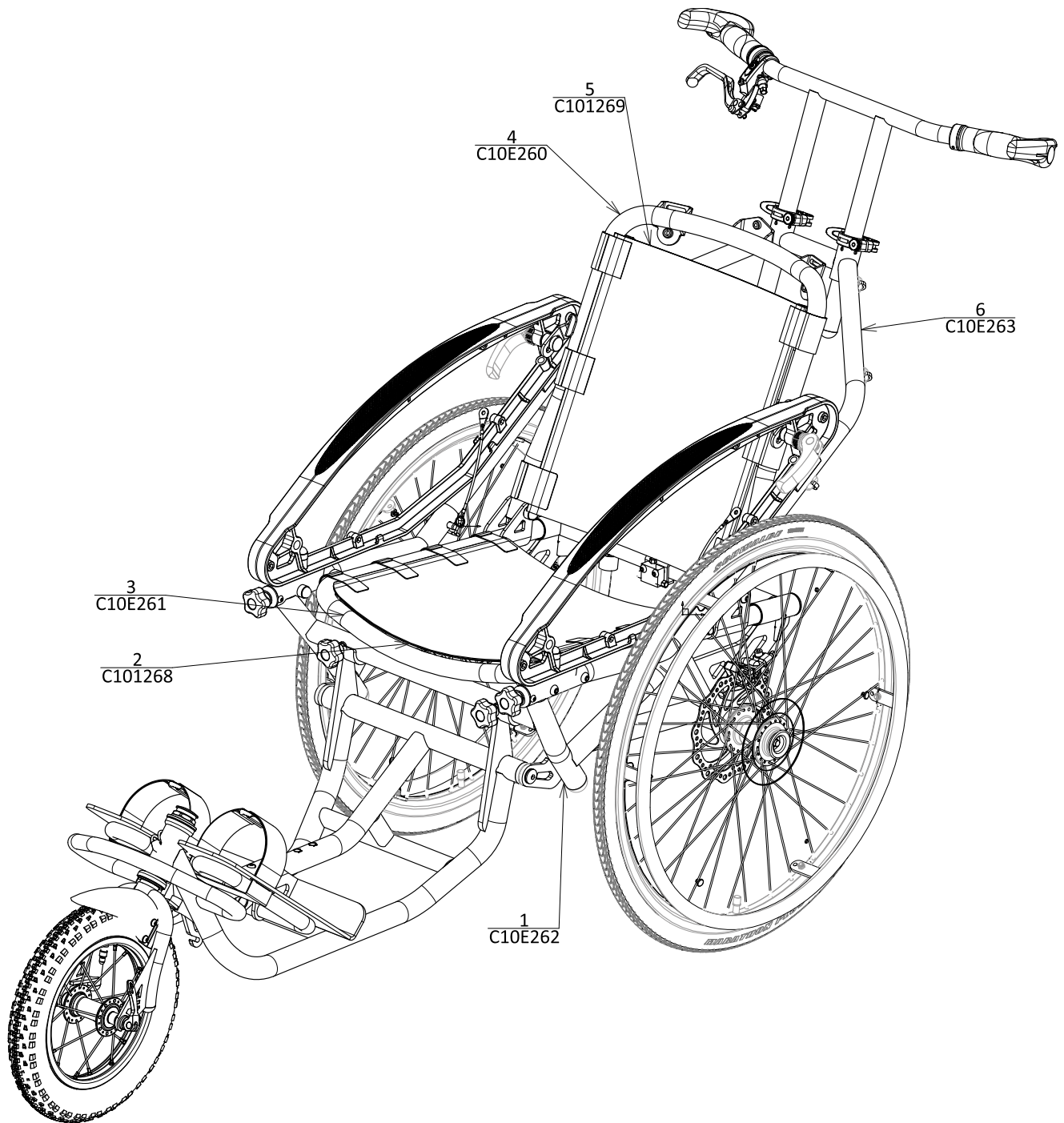

EXPLODED VIEW OF THE JOËLETTE FINISHER SIZE 48

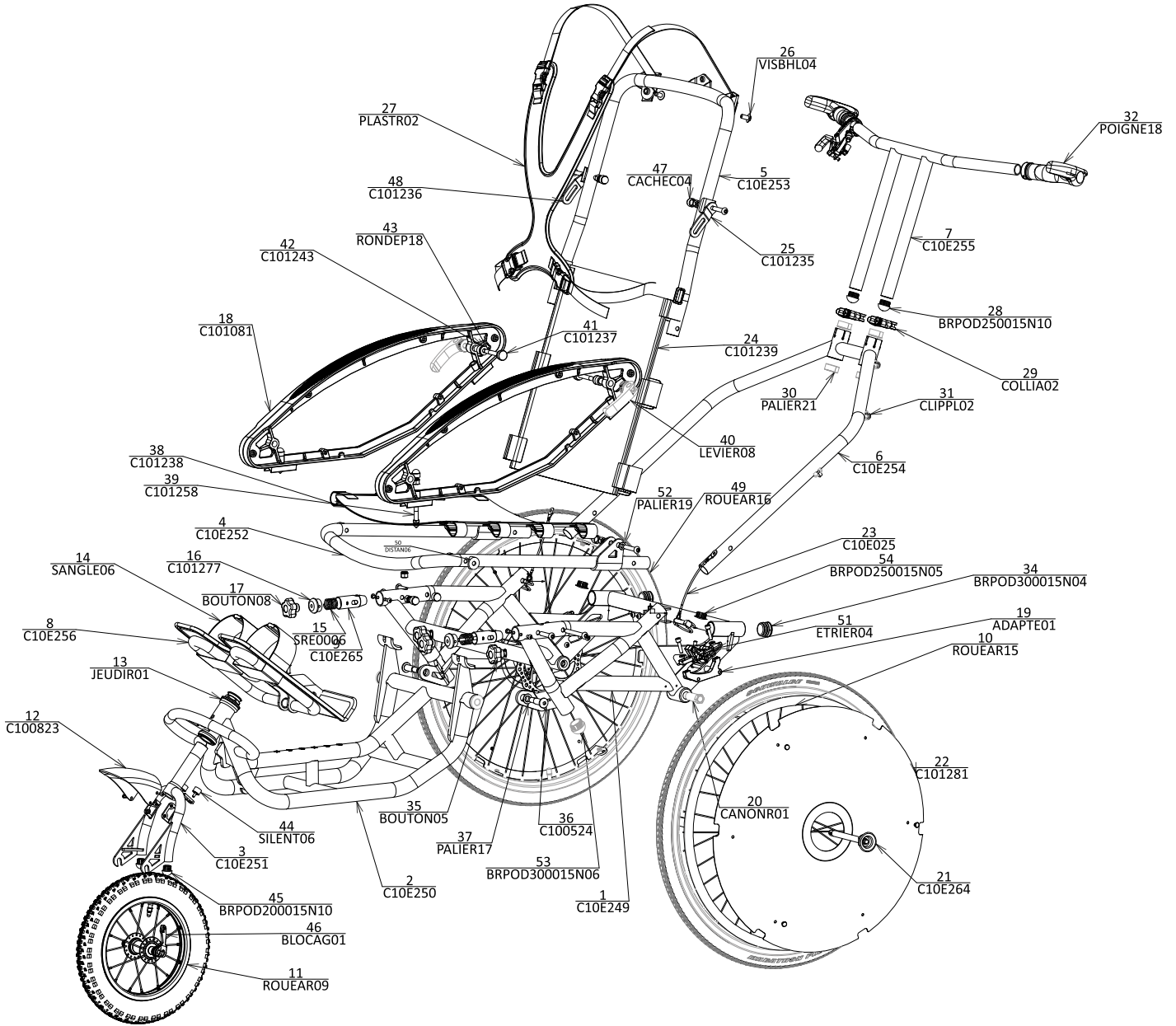

UNFOLDING THE JOËLETTE FINISHER



1. Take the Joëlette Finisher out of the bag (optional) and place it on the ground with the handlebars up.

2. Grasp the handlebars and place them in their housing.



3. Remove the two safety pins. Then insert the two handlebar arms into the sockets provided on the chassis. Finally, replace the safety pins.



4. Loosen the handlebar quick-release levers to adjust the handlebar to the correct height.

5. Retighten the quick-release levers.



6. Tilt the footrest forward as far as it will go (be careful not to trap fingers/hands).



7. Lock the footrest using the buttons.

8. Insert the disc of each wheel between the brake pads.

9. Insert the ball spindles until they lock (check that they lock by pulling on the wheel).



10. Lift the backrest.



11. Insert the front of the armrest into the frame.



12. Lock each armrest by tightening the knobs.



13. Unscrew the knurled pins on the armrest.



14. Fit these pins into the backrest plates and screw into the quick-release lever.



15. Tilt the quick-release lever once you have chosen the backrest angle.



16. Insert the front wheel into the fork.



17. Then tighten it using the quick-release lever.

To dismantle, proceed in reverse order, taking care not to jam or pinch hands or fingers on moving parts.

When dismantling/bending, take care not to pinch or bend the brake hose(s).

**A video is available
on our website**

www.joletteandco.com

MAINTENANCE

MAINTENANCE

The term «Maintenance» refers to any activity that keeps the Joëlette Finisher in good condition and roadworthy. Maintenance includes such things as regular cleaning, inspections, repairs and general servicing.

It should be carried out at least once a year, regardless of the frequency of use. A second service is required if the equipment is used regularly (several times a week).

Maintenance involves checking :

- Tyre pressure
- The correct operation of the braking system, in particular the condition of the brake pad linings. A brake lever that is a little «soft» will not provide optimum braking. The lever must not come to rest on the rear handlebars before braking is at its maximum.
- The presence of safety pins.
- If the handle feels «spongy» even though the linings are new or in good condition, check and top up the fluid level in the brake master cylinder if necessary. Brake fluid is available from all cycle shops.
- There is no fluid leaking from the hose at the brake lever or caliper. If there is a leak or loss of pressure, contact a specialist.
- If you need to work on the hydraulic braking system, particularly when changing brake pads, we can supply you with a system bleeding kit.
- You will find red, yellow or black plastic shims between the brake pads, to be inserted between the two pads if the two rear wheels are removed and each time the Joëlette Finisher is folded.
- We recommend that you always carry a puncture-proof spray on each Joëlette Finisher.

We strongly recommend that maintenance is carried out by a professional.

CLEANING

When cleaning the Joëlette Finisher, please observe the following points:

- Use only a damp cloth and a mild, skin-friendly, non-allergenic cleaning product.
- Do not use abrasive cleaning products.
- Do not use high-pressure cleaners.
- As the cushion covers are made from PVC sheeting, you can easily clean the surface.

DISINFECTION

Disinfection using tested and recognised disinfectant products on a damp cloth or by spraying is permitted. A list of disinfectants currently authorised for cleaning with a damp cloth or spray can be obtained from the Robert Koch Institute at <http://www.rki.de>.

We recommend disinfecting the Joëlette Finisher before each use and at least between each different passenger to avoid the risk of cross-contamination.

INSPECTION CHECKS

The following tables list the inspections that the user should carry out at the corresponding intervals.

Before each use of the Joëlette Finisher

ELEMENTS	INSPECTION CHEKS	IN CASE OF FAILURE
SEAT LOCKING SYSTEM	Make sure that the front frame tightening knobs are working properly.	Contact us
TIRES	Make sure the tyres are not damaged and that there are no leaks from the inflation valve.	Contact us or get in touch with a cycle equipment retailer.
	Make sure the tyre is inflated to the correct pressure.	Inflate the tyre. Refer to the main wheel tyre table in the «Technical specifications» chapter. To have the inner tube repaired, contact us or your cycle dealer.
SAFETY PINS AND PINS PRESENT	Heck that the handlebar support safety pins are still in place. We recommend changing the safety pins and "beta" pins every 5 years.	Contact us
HOLDING DEVICE	Make sure that the locking buckles do their job properly. Check that there is no damage to the seams or lashing karabiners.	Contact us

BRAKING	Make sure the brake works.	Contact us
	Check that the lever on the handlebar is tight.	Retighten the lever.
	Check that the brake hose loops are not broken or loose.	Contact us

Regularly

ELEMENTS	INSPECTION CHEKS	IN CASE OF FAILURE
ALL PARTS PADDED	Check the straps holding the seat cushion and backrest together and the Velcro strip holding the backrest to the frame for damage and wear.	Contact us
BRAKING	Check that the brake pads are not excessively worn.	Contact us or get in touch with a cycle dealer.
	Check that the brake fluid level in the master cylinder is sufficient.	Get in touch with a cycle dealer

LONG TERM STORAGE

If you are not going to use your Joëlette Finisher for an extended period of time, you should prepare it for storage in order to increase its lifespan.

We recommend storing the Joëlette at a temperature of 15°C and avoiding extreme temperatures in order to prolong its life and that of its accessories.

The components are tested and approved for the higher temperature ranges detailed below:

- The authorised temperature range for storing the vehicle is between -40°C and +65°C.

Store in a dry, well-ventilated environment protected from external influences.

Inflate the tyre slightly.

DANGER !

Risk of material damage or serious or even fatal injury

Incorrect repair and/or maintenance of the Joëlette by users/carers or by unqualified technicians may result in material damage or serious injury, even death.

- **DO NOT** carry out any maintenance work other than that described in this manual.

Such repairs and/or maintenance **MUST** be carried out by the manufacturer or by competent personnel.

AFTER USE

DISPOSAL

- The packaging of the Joëlette Finisher will be recycled.
- Metal parts are recycled as scrap metal.
- Plastic parts are sent for plastics recycling.
- Waste must be managed in accordance with the relevant national regulations.

TECHNICAL DATA

The technical information provided in this document applies to the standard configuration for the Joëlette Finisher or represents theoretical maximum values.

These characteristics may change if accessories are added.

Nb: Note that in some cases, the measured values may vary by +/- 10mm.

AUTHORISED CONDITIONS AND PLACES OF USE AND STORAGE	
OPERATING TEMPERATURE RANGE	from -25°C to +50°C
RECOMMENDED STORAGE TEMPERATURE	15°C
STORAGE TEMPERATURE RANGE	from 0°C to +50°C

WHEEL TIRE	
TIRE TYPE	Rear: 24" x 1" pneumatic Front: 12" x 2" pneumatic
PRESSURE	The maximum inflation pressure recommended for the tyre in bar or kPa is indicated on the inner wall of the tyre. If several values are indicated, the lowest in the corresponding unit applies.

DIMENSIONS	JOËLETTE FINISHER SIZE 42 (WITHOUT HEADREST)	JOËLETTE FINISHER SIZE 48 (WITHOUT HEADREST)
MAXIMUM OVERALL HEIGHT	1082 mm	1082 mm
TOTAL WIDTH	648 mm	708 mm
TOTAL LENGTH	1755 mm	1755 mm
ROLLING SEAT HEIGHT	470 mm in the middle of the cushion	470 mm in the middle of the cushion
SEAT WIDTH	420 mm	480 mm
SEAT DEPTH	400 mm	421 mm
MINIMUM SEAT THICKNESS	16 mm	16 mm
BACKREST HEIGHT	420 mm	460 mm
MINIMUM BACKREST THICKNESS	16 mm	16 mm
BACKREST ANGLE	100° / 111°	100° / 111°
SEAT ANGLE	8°	8°
ARMREST HEIGHT	280 mm	280 mm
ARMREST LENGTH	400 mm	400 mm
DISTANCE FOOTREST / SEAT	de 338 mm à 352 mm	de 338 mm à 352 mm
GROUND CLEARANCE	150 mm	150 mm
FOLDED SIZE	980(L) x 620(W) x 530(H)	980(L) x 620(W) x 530(H)

	JOËLETTE FINISHER SIZE 42 (WITHOUT HEADREST)	JOËLETTE FINISHER SIZE 48 (WITHOUT HEADREST)
TARE WEIGHT	20 Kg	20 Kg
MAXIMUM LOAD	80 Kg	100 Kg

HEADREST ASSEMBLY (OPTIONAL)



1. Secure the plastic flange to the back of the backrest using the screws supplied.

2. Screw the knob loosely into place.



3. Slide the headrest into its housing on the back of the backrest.



4. Tighten the knob to secure the headrest.

Beware of jamming and pinching hands and fingers with moving parts.





Joëlette and Co
by Ferriol-Matrat

The pictograms below can be found in this user manual and on the product label:

 Complies with the essential requirements of the European legislation applicable to the product

 Warning: it is essential to consult the user manual

 Please note: special points for your attention

 This marking indicates that within the EU this product must not be disposed of with household waste. In order to prevent possible damage to the environment or human health due to uncontrolled disposal, recycle this appliance responsibly to encourage the sustainable reuse of materials. To return your used appliance, use the return and collection systems or contact the retailer from whom you purchased the product. They will be able to recycle this product in an environmentally friendly way.

 Catalogue reference

 Manufacturer

 YYYY-MM Date of manufacture (year-month)

 Batch number

 Serial number

CONTACT

**PLEASE CONTACT THE JOËLETTE AND CO TEAM
IF YOU HAVE ANY QUESTIONS**

 export@joëletteandco.com

SAV : jc-odin@joëletteandco.com

 **0033 (0)4 - 77 - 42 - 62 - 58**

JOIN THE JOËLETTE'S COMMUNITY ON SOCIAL NETWORKS!



@FERRIOL-MATRAT - ALL RIGHTS RESERVED

This manual is protected by the law of 11 March 1957 on literary and artistic property, supplemented by the law of 3 July 1985 and by all conventions applicable to copyright. In application of these laws and conventions, no reproduction or copy, in whole or in part, of the manual, programmes or systems is authorised without the prior written consent of FERRIOL-MATRAT. FERRIOL-MATRAT reserves the right to revise and improve these products. This publication describes the state of the product at the time of publication and does not prejudice any changes it may undergo.

